

Proposed First Floor Plan 1:50 @ A1

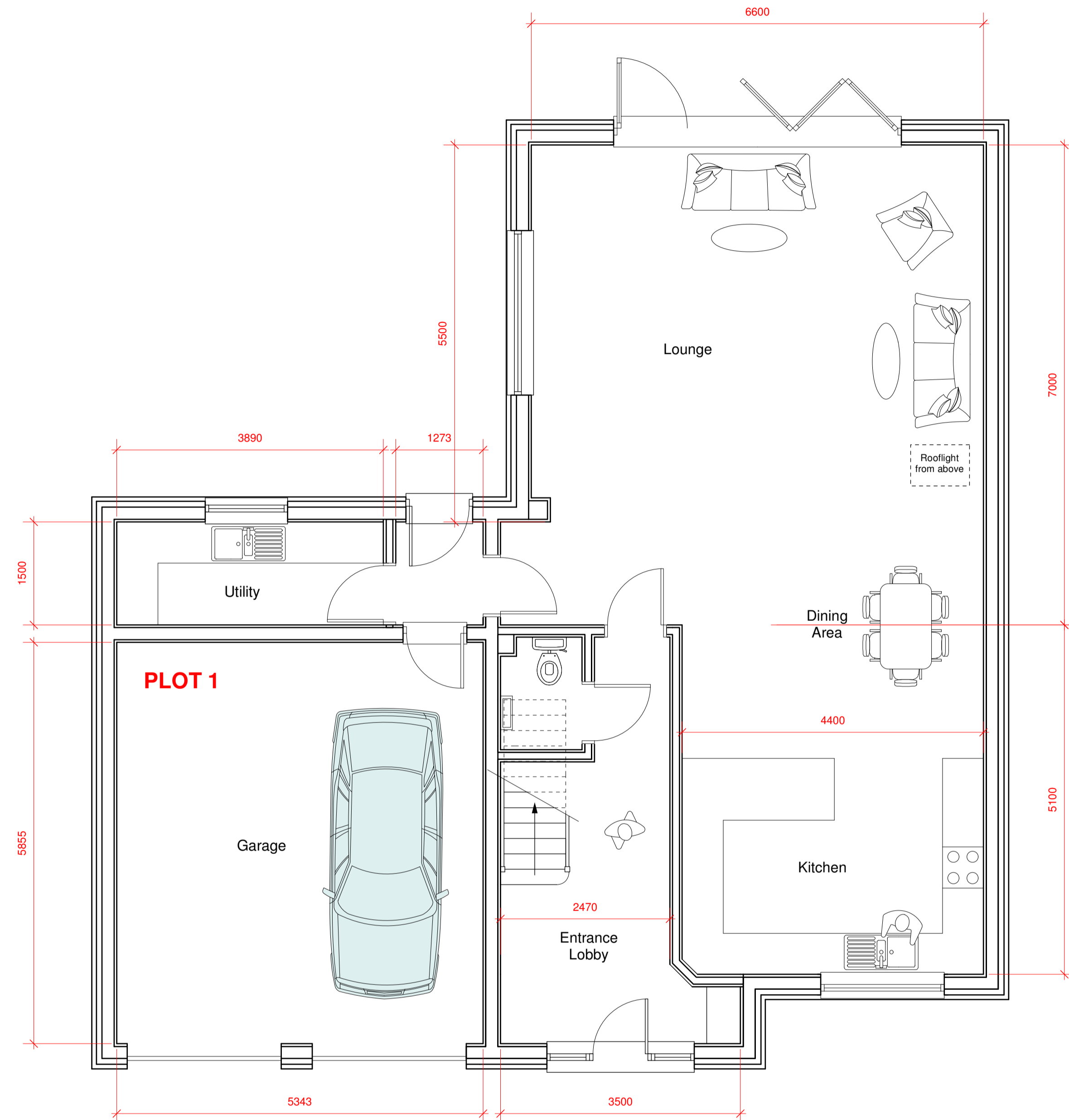

Proposed Ground Floor Plan 1:50 @ A1



BUILDING REGULATION ISSUE

**Proposed Residential Development on
Land at Gaymers Lane, Trimley St. Mary,
Felixstowe, Suffolk, IP11 0TW.
For Mr. L. Crossley**
Date: Oct. 2023 Scale: 1:50 Dwg No. TL-3953-23-SK1
Proposed Room Dimensions

Anglia Design
architects . surveyors

mail@angliadesign.co.uk www.angliadesign.co.uk

London Office: 30 Robin House, Newcourt Street, St Johns Wood, London NW8 7AD
Tel: 020 7722 9559 Fax: 020 731 3804

Norwich Office: 11 Claving Cross, Norwich, Norfolk, NR2 4AX
Tel: 01603 486679